



FIX-WSD10TII



FIX-MAG-WSD10TII

**Capetti**  
ELETTRONICA

**WSD10TII**

**WSD10TII**

## Fastening systems.

Accessories for magnetically fixing or gluing the **WSD10TII** wireless tiltmeter.

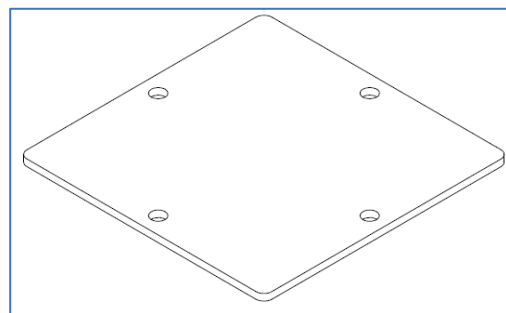

### Suitable to:

- Wall mounting
- Fixing on horizontal plane
- Inclined plane fixing

- **FIX-WSD10TII:** Kit consisting of fixing plate and screws for 'bonded' applications with mounting glue sealant.
- **FIX-MAG-WSD10TII:** Kit consisting of 4 neodymium magnets and fixing screws for applications on metal structures.



**FIX-WSD10TII**

**FIX-MAG-WSD10TII**

## General technical specifications

### FIX-WSD10TII

<b>Dimensions</b>	149.8x149.8x4.0mm
<b>Material</b>	galvanised iron
<b>Drillings</b>	4x8MA - threaded

### FIX-MAG-WSD10TII

<b>Diameter</b>	20mm
<b>Thickness</b>	6mm
<b>Threading</b>	M4
<b>Weight</b>	0.011Kg
<b>Traction force</b>	Up to 7.0Kg
<b>Material</b>	Neodymium
<b>Maximum operative temperature</b>	80°C

Capetti  
ELETTRONICA



## FIX-WSD10TII

## FIX-MAG-WSD10TII

The [WSD10TII](#) wireless tiltmeter can be installed in any position, thanks to its integrated measuring axis zeroing functionality.

The FIX-WSD10TII 'glue-down' mounting system allows the datalogger to be fixed to any surface, without the need for dowelling or drilling.

At the end of the monitoring campaign, the [WSD10TII](#) can be removed from the glued mount, which will serve as a pre-installed holder for a possible new measurement campaign.

The magnetic fixing system consists of 4 neodymium magnets and fixing screws, which allows the [WSD10TII](#) to be placed on metal structures.

The FIX-MAG-WSD10TII kit guarantees a tensile force of up to 7 kg under extreme working conditions and can withstand temperatures of up to 80°C.

Completely removable at the end of the monitoring campaign, it can be reused.

Capetti  
ELETTRONICA

*The features shown may be subject to change without notice.*